

- ACCESSIBLE PASSENGER LOADING ZONE
- ACCESSIBLE PARKING
- ACCESSIBLE ROUTE
- EXISTING PLAYGROUND
- ADMISSIONS
- BATHHOUSE (INCLUDING MEN'S AND WOMEN'S LOCKER ROOMS, SINGLE USER TOILETS AND SHOWER ROOMS, NURSING ROOM, ADMISSIONS, GUARD LOCKER ROOMS, FIRST AID, POOL MANAGER, AND COMMUNITY/PARTY ROOM)
- COMMUNITY/PARTY ROOM
- SINGLE USER TOILETS FOR PARK
- POOL MANAGER
- ACTIVITY POOL WITH ZERO-DEPTH ENTRY
- CURRENT CHANNEL
- LAP POOL 6 LANES - 50 METERS
- LAWN
- SHADE STRUCTURES
- DEEP POOL WITH 1 METER AND 3 METER DIVING
- FILTER BUILDING

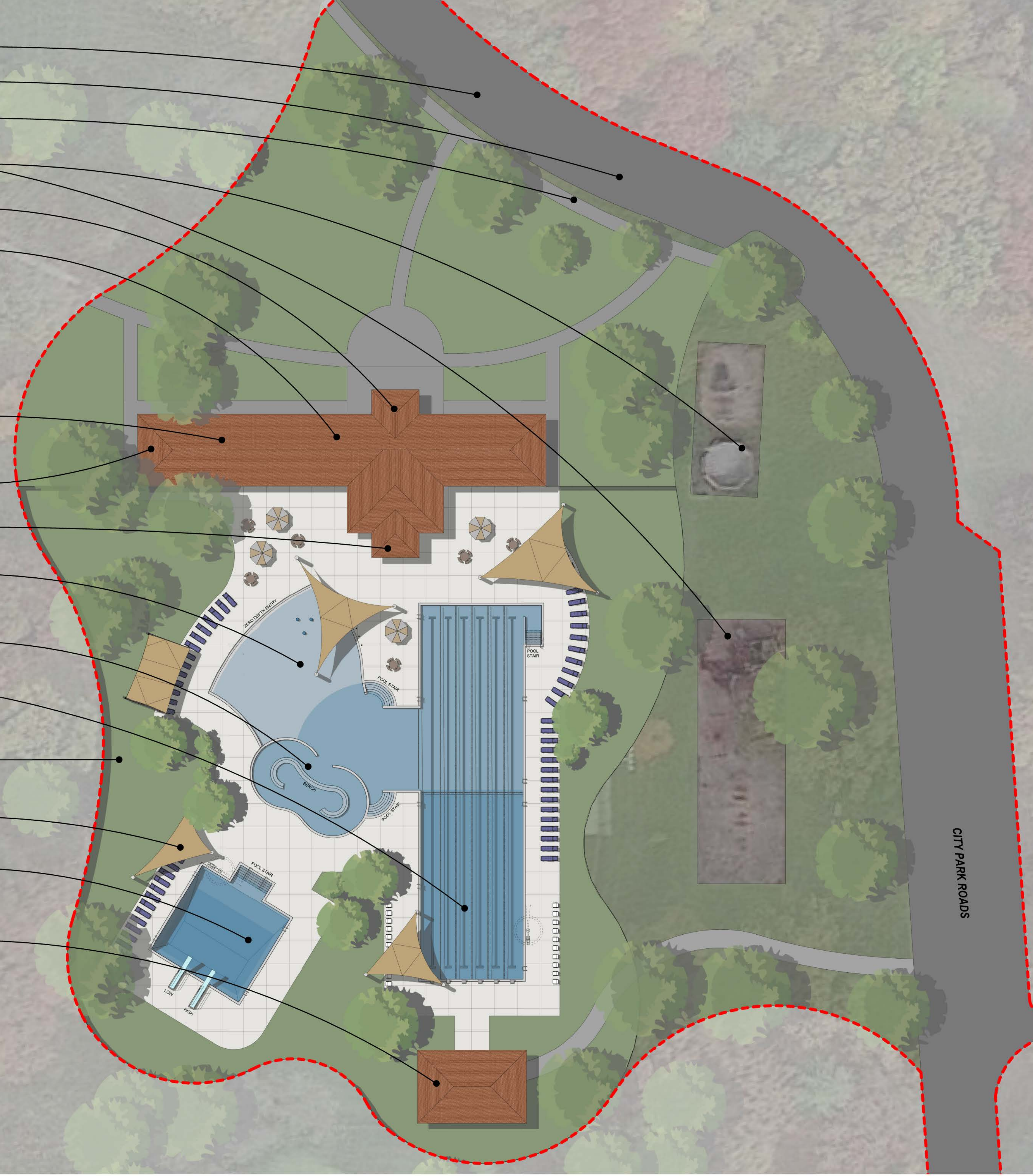

**OPTION A - FREE FORM ACTIVITY POOL ATTACHED TO LAP POOL**

- SIX 50 METER LAP LANES IN 3 ½ TO 5 FOOT DEEP WATER. ZERO DEPTH ENTRY THROUGH ACTIVITY AREA AND INTEGRATED ACCESSIBLE STAIR ENTRY. WILL ALLOW FOR ADDITIONAL LAP SWIM TIME SINCE 2-3 LAP LANES WOULD LIKELY BE AVAILABLE DURING ALL OPEN SWIM HOURS. LAP LANES ARE OF A DEPTH FOR BOTH SWIMMING, WATER WALKING AND AQUA FITNESS.
- ATTACHED ORGANICALLY SHAPED ZERO-DEPTH ENTRY ACTIVITY POOL WITH DEPTH UP TO 3 ½ FEET. INCLUDES CURRENT CHANNEL AND OTHER BUBBLER/SPRAY FEATURES. NO PLAY STRUCTURE WITH THIS OPTION.
- SEPARATE DEEP POOL WITH LOW AND HIGH DIVING BOARDS. INTEGRATED ACCESSIBLE STAIR ENTRY.
- ESTIMATED 495,600 GALLONS OF WATER VOLUME (CURRENT CITY PARK POOL IS 751,575 GALLONS). THIS IS 34% LESS WATER THAN THE CURRENT POOL.
- MAXIMUM BATHER LOAD: 975
- COST ESTIMATE: \$18.39 MILLION

**CURRENT CHANNEL:**



**IOWA CITY | CITY PARK POOL | OPTION A**

**\$18.39M**

<b>PROPOSED BATHER LOAD:</b> 975 PATRONS <small>(CURRENT BATHER LOAD: 1082 PATRONS)</small>	<b>PROPOSED POOL VOLUME:</b> ACTIVITY/LAP POOL: 348,855 GALLONS DEEP POOL: 146,745 GALLONS TOTAL POOL: 495,600 GALLONS <small>(CURRENT POOL: 751,575 GALLONS)</small>	2023-040 FEBRUARY 7 2024 SCALE: 1" = 20'-0" 	NORTH 
---	---	---	-----------

- ACCESSIBLE PASSENGER LOADING ZONE
- ACCESSIBLE PARKING
- ACCESSIBLE ROUTE
- EXISTING PLAYGROUND
- ADMISSIONS
- BATHHOUSE (INCLUDING MEN'S AND WOMEN'S LOCKER ROOMS, SINGLE USER TOILETS AND SHOWER ROOMS, NURSING ROOM, ADMISSIONS, GUARD LOCKER ROOMS, FIRST AID, POOL MANAGER, AND COMMUNITY/PARTY ROOM)
- COMMUNITY/PARTY ROOM
- SINGLE USER TOILETS FOR PARK
- POOL MANAGER
- ACTIVITY POOL WITH ZERO-DEPTH ENTRY
- LAP POOL 6 LANES - 50 METERS
- LAWN
- SHADE STRUCTURES
- DEEP POOL WITH 1 METER AND 3 METER DIVING
- FILTER BUILDING

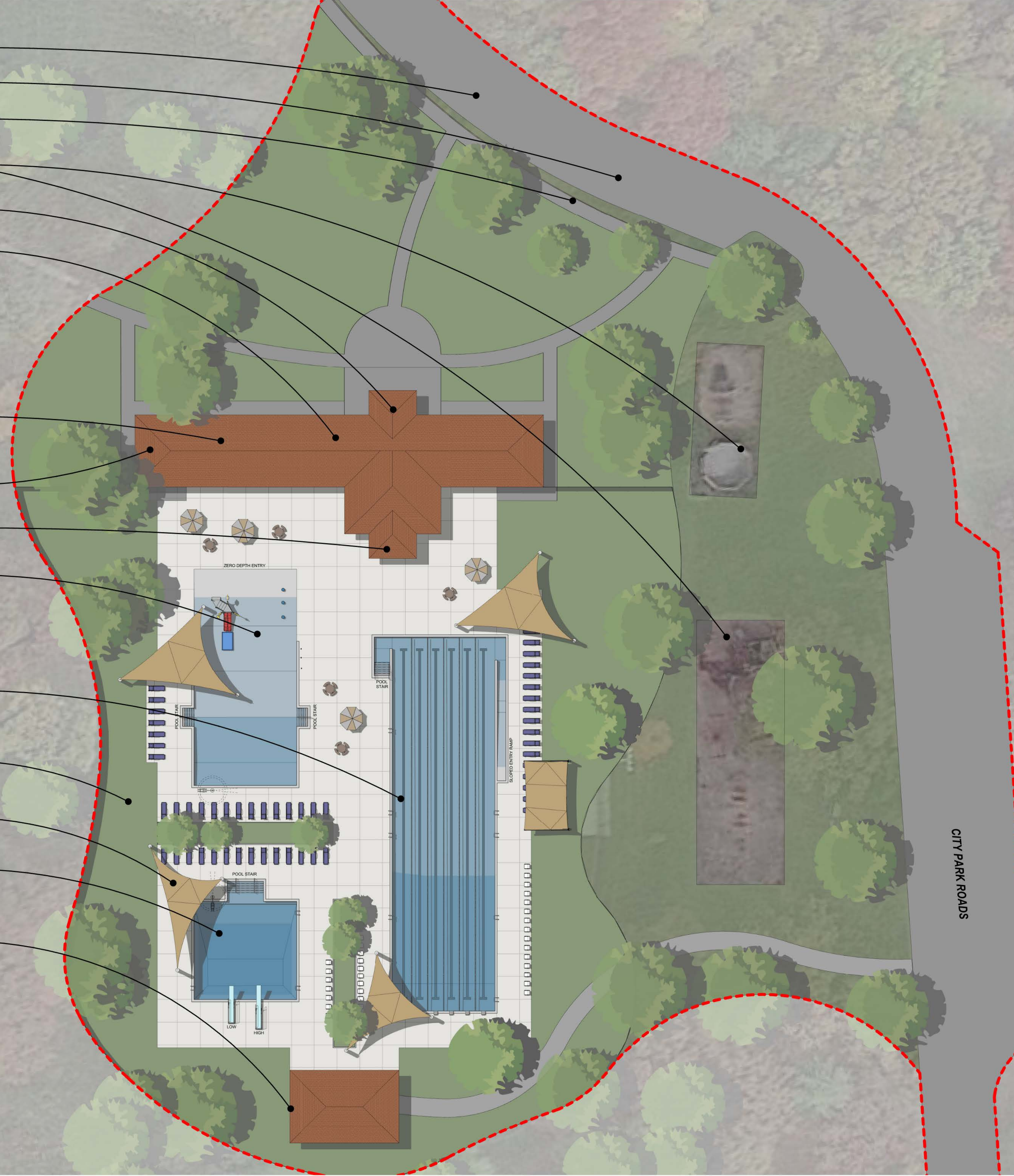

**OPTION B – 3 SEPARATE POOLS**

- SEPARATE POOL WITH SIX 50 METER LAP LANES IN 3 ½ TO 5 FOOT DEEP WATER. INTEGRATED ACCESSIBLE SLOPED ENTRY RAMP & STAIR ENTRY. WILL ALLOW FOR ADDITIONAL LAP SWIM TIME SINCE 2-3 LAP LANES WOULD LIKELY BE AVAILABLE DURING ALL OPEN SWIM HOURS. LAP LANES ARE OF A DEPTH FOR BOTH SWIMMING, WATER WALKING AND AQUA FITNESS.
- SEPARATE ZERO-DEPTH ENTRY ACTIVITY POOL WITH DEPTH UP TO 3 ½ FEET. INCLUDES PLAY STRUCTURE AND OTHER BUBBLER/SPRAY FEATURES.
- SEPARATE DEEP POOL WITH LOW AND HIGH DIVING BOARDS. INTEGRATED ACCESSIBLE STAIR ENTRY.
- SEPARATE POOLS WILL ALLOW FOR MORE OPTIONS WITH PROGRAMMING THROUGHOUT THE DAY AS EACH POOL MAY BE OPENED, CLOSED OR PROGRAMMED INDEPENDENTLY FROM THE OTHERS.
- SEPARATE POOLS WILL ALLOW EACH TO OPERATE INDEPENDENTLY. IF ONE POOL NEEDS TO BE CLOSED FOR REPAIRS OR CLEANING, THE OTHER TWO COULD REMAIN OPEN.
- ESTIMATED 458,555 GALLONS OF WATER VOLUME (CURRENT CITY PARK POOL IS 751,575 GALLONS). THIS IS 39% LESS WATER THAN THE CURRENT POOL.
- MAXIMUM BATHER LOAD: 881
- COST ESTIMATE: \$17.94 MILLION

**IOWA CITY | CITY PARK POOL | OPTION B**

**\$17.94M**

<b>PROPOSED BATHER LOAD:</b> 881 PATRONS <small>(CURRENT BATHER LOAD: 1082 PATRONS)</small>	<b>PROPOSED POOL VOLUME:</b> LAP POOL: 240,865 GALLONS ACTIVITY POOL: 70,945 GALLONS DEEP POOL: 146,745 GALLONS TOTAL POOL: 458,555 GALLONS <small>(CURRENT POOL: 751,575 GALLONS)</small>	2023-040 FEBRUARY 7 2024 SCALE: 1" = 20'-0" 
---	---	---

- ACCESSIBLE PASSENGER LOADING ZONE
- ACCESSIBLE PARKING
- ACCESSIBLE ROUTE
- EXISTING PLAYGROUND
- ADMISSIONS
- BATHHOUSE (INCLUDING MEN'S AND WOMEN'S LOCKER ROOMS, SINGLE USER TOILETS AND SHOWER ROOMS, NURSING ROOM, ADMISSIONS, GUARD LOCKER ROOMS, FIRST AID, POOL MANAGER, AND COMMUNITY/PARTY ROOM)
- COMMUNITY/PARTY ROOM
- SINGLE USER TOILETS FOR PARK
- POOL MANAGER
- ACTIVITY POOL WITH ZERO-DEPTH ENTRY
- SHADE STRUCTURES
- LAWN
- LAP POOL 6 LANES - 50 METERS
- DEEP POOL WITH 1 METER AND 3 METER DIVING
- FILTER BUILDING



**OPTION C - "L" SHAPED COMBINED LAP & ACTIVITY POOL**

- SIX 50 METER LAP LANES IN 3 ½ TO 5 FOOT DEEP WATER. ZERO DEPTH ENTRY THROUGH ACTIVITY AREA AND INTEGRATED ACCESSIBLE STAIR ENTRY. WILL ALLOW FOR ADDITIONAL LAP SWIM TIME SINCE 2-3 LAP LANES WOULD LIKELY BE AVAILABLE DURING ALL OPEN SWIM HOURS. LAP LANES ARE OF A DEPTH FOR BOTH SWIMMING, WATER WALKING AND AQUA FITNESS.
- ATTACHED RECTANGULAR ZERO-DEPTH ENTRY ACTIVITY POOL WITH DEPTH UP TO 3 ½ FEET. INCLUDES PLAY STRUCTURE AND OTHER BUBBLER/SPRAY FEATURES.
- SEPARATE DEEP POOL WITH LOW AND HIGH DIVING BOARDS. INTEGRATED ACCESSIBLE STAIR ENTRY.
- ESTIMATED 443,700 GALLONS OF WATER VOLUME (CURRENT CITY PARK POOL IS 751,575 GALLONS). THIS IS 41% LESS WATER THAN THE CURRENT POOL.
- MAXIMUM BATHER LOAD: 825
- COST ESTIMATE: \$17.25 MILLION

**IOWA CITY | CITY PARK POOL | OPTION C**

**\$17.25M**

<b>PROPOSED BATHER LOAD:</b> 825 PATRONS <small>(CURRENT BATHER LOAD: 1082 PATRONS)</small>	<b>PROPOSED POOL VOLUME:</b> ACTIVITY/LAP POOL: 298,955 GALLONS DEEP POOL: 146,745 GALLONS TOTAL POOL: 443,700 GALLONS <small>(CURRENT POOL: 751,575 GALLONS)</small>	2023-040 FEBRUARY 7 2024 SCALE: 1" = 20'-0" 	
---	---	---	--

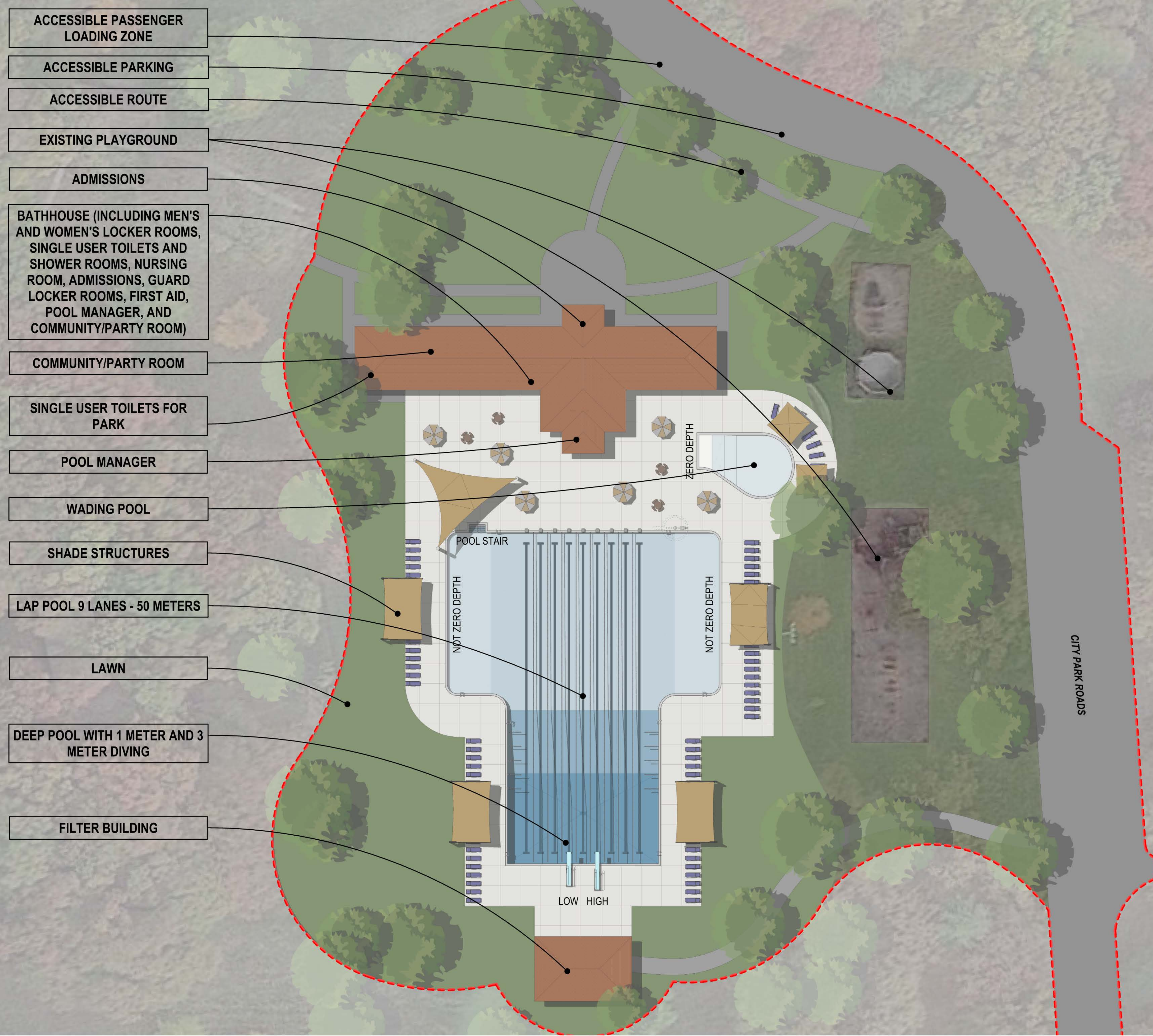

- ACCESSIBLE PASSENGER LOADING ZONE
- ACCESSIBLE PARKING
- ACCESSIBLE ROUTE
- EXISTING PLAYGROUND
- ADMISSIONS
- BATHHOUSE (INCLUDING MEN'S AND WOMEN'S LOCKER ROOMS, SINGLE USER TOILETS AND SHOWER ROOMS, NURSING ROOM, ADMISSIONS, GUARD LOCKER ROOMS, FIRST AID, POOL MANAGER, AND COMMUNITY/PARTY ROOM)
- COMMUNITY/PARTY ROOM
- SINGLE USER TOILETS FOR PARK
- POOL MANAGER
- WADING POOL
- SHADE STRUCTURES
- LAP POOL 9 LANES - 50 METERS
- LAWN
- DEEP POOL WITH 1 METER AND 3 METER DIVING
- FILTER BUILDING

**OPTION D – REPLACE POOL AND WADING POOL THE SAME AS CURRENT POOL.**

- ONE LARGE POOL WITH SEPARATE WADING POOL. NINE 50 LAP LANES WITH TWO “WINGS” OF SHALLOW WATER. LAP LANE DEPTH FROM 3½ TO 13 FEET DEEP. DIVING AREA WITHIN THE LAP LANE AREA. LAP LANES AVAILABLE DURING LIMITED “LAP SWIM” HOURS. OPEN FOR GENERAL SWIM THE REMAINDER OF THE DAY.
- INTEGRATED ACCESSIBLE STAIR ENTRY AT LARGE POOL. NO ZERO-DEPTH ENTRY AT LARGE POOL. SMALL ZERO-DEPTH ENTRY AT WADING POOL ONLY.
- ESTIMATED 751,575 GALLONS OF WATER VOLUME. THIS IS THE SAME AS THE CURRENT POOL.
- MAXIMUM BATHER LOAD: 1,082
- COST ESTIMATE: \$19.56 MILLION

**IOWA CITY | CITY PARK POOL | OPTION D**

**\$19.56M**

<b>PROPOSED BATHER LOAD:</b> 1082 PATRONS	<b>PROPOSED POOL VOLUME:</b>
(CURRENT BATHER LOAD: 1082 PATRONS)	MAIN POOL: 750,000 GALLONS WADING POOL: 1,575 GALLONS TOTAL POOL: 751,575 GALLONS (CURRENT POOL: 751,575 GALLONS)

2023-040 FEBRUARY 7 2024 SCALE: 1" = 20'-0"
---

